

**TO INSTALL: SPLITTER PUCK**

- 1 a. Use the Drilling Template to mark out the mounting hole (1) along with the power cable slot (2).
- b. Carefully drill and cut-out the marked mounting points.

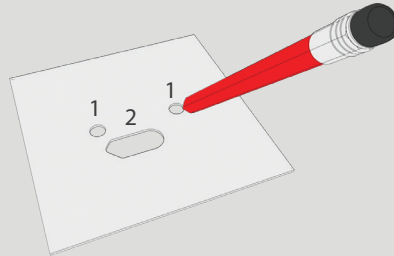

When using adhesive only drill power cable slot (2)

- 2a. Slide the power cable into the power cable cut-out slot and align the Splitter Puck over the mounting holes.
- b. Screw in the two M5 Screws (not included).



3. Connect the Standard, Boost or Boost plus power cable to Splitter Puck connection.  
On connection there will be a red LED followed by a 'beep'.

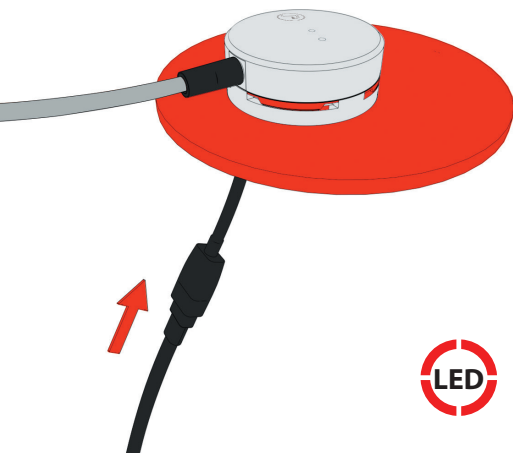

**TO INSTALL: SPLITTER 2**

1. Loop cable around the product.



- 2a. Using the Tetrakey rotate anti-clockwise to release the Pendant.
- b. Lift and open the Pendant.

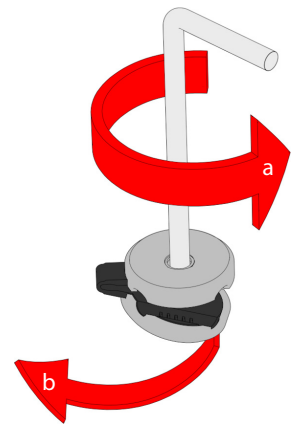

3. Connect the power and alarm cable.

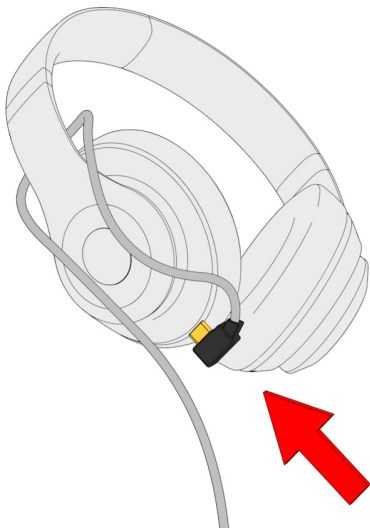

4. Attach the Pendant to the cable and close the Pendant with the J-Plug logo facing you.

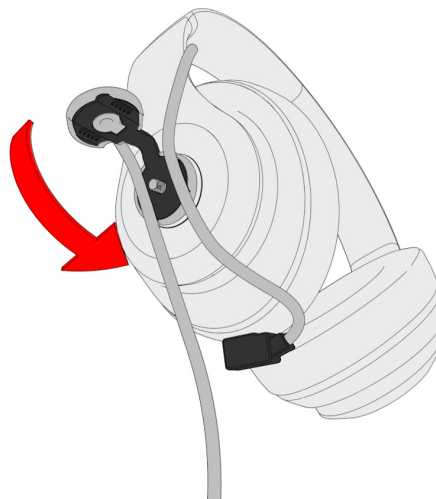

5. Using the Tetrakey screw clockwise to secure the Pendant.





**TO INSTALL: AUDIO LOCK**

**1.** Insert Audio Lock into the 3.5 audio socket.

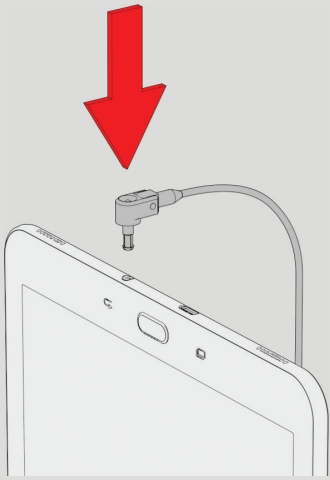

**2.** Using Tetrakey apply pressure while turning clockwise slowly, until the Audio Lock is secured in the audio socket.

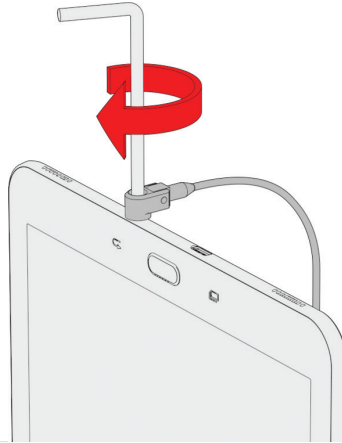

**3.** Plug in connector to your device and it will automatically alarm and charge.

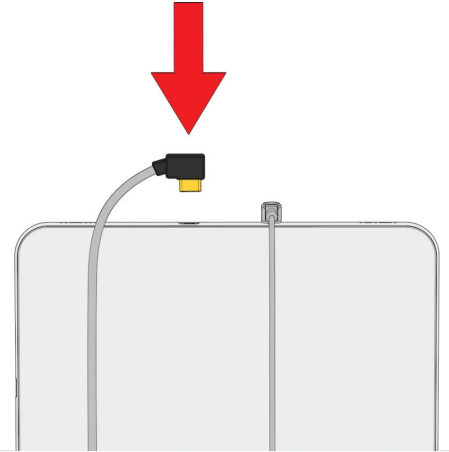

**4a.** Using the Tetrakey rotate anti-clockwise to release the Pendant.

**b.** Lift and open the Pendant.

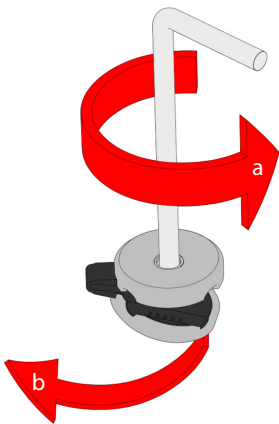

**5.** Attach the Pendant to the cable and close the Pendant.

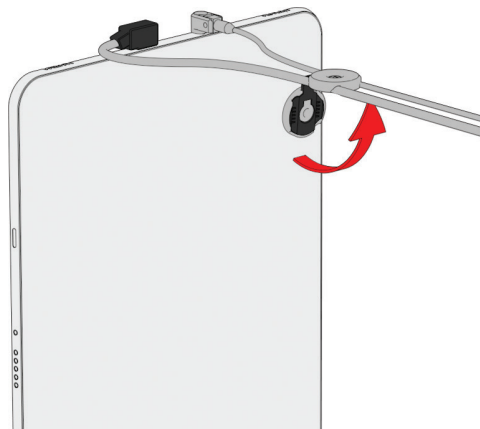

**6.** Using the Tetrakey screw clockwise to secure the Pendant.

